

Clark Community Park

Old Saybrook, CT, USA
 scale 1:7500
 contours 5 meters

- paved road, dirt road
- dirt parking area
- large path, small path
- faint path
- stone wall
- ruined wall
- uncrossable fence
- crossable fence
- buildings, ruin
- contours (5 meter)
- form line
- knolls
- depression, pit
- cliffs
- boulders, cluster
- disc golf hole
- private property
- open land
- rough open land
- semi-open land
- vegetation, slow
- vegetation, walk
- vegetation, fight
- lake
- swamp
- crossable marsh

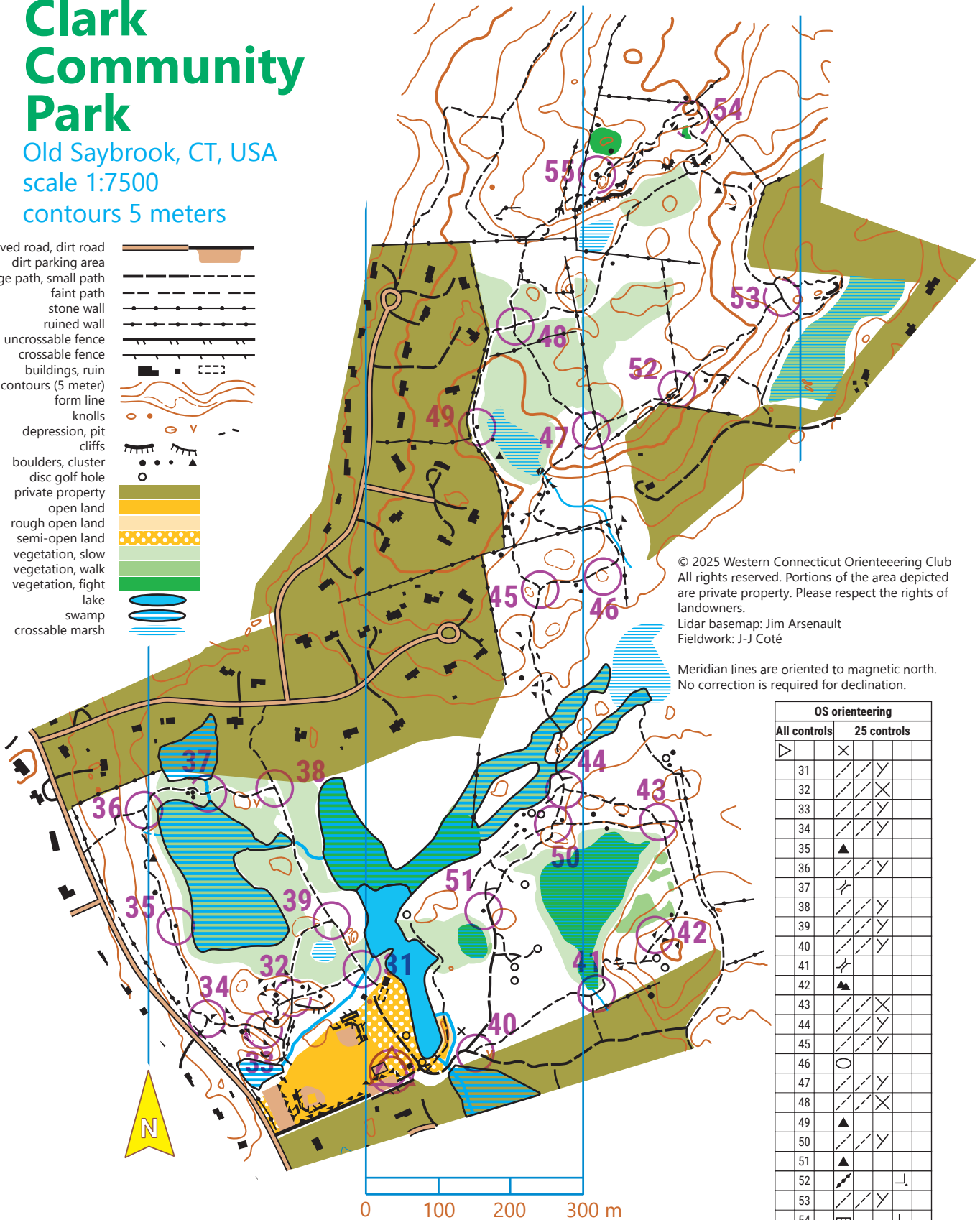

© 2025 Western Connecticut Orienteering Club
 All rights reserved. Portions of the area depicted are private property. Please respect the rights of landowners.
 Lidar basemap: Jim Arsenault
 Fieldwork: J-J Côté

Meridian lines are oriented to magnetic north.
 No correction is required for declination.

OS orienteering			
All controls	25 controls		
▶	×		
31	↗	↘	
32	↗	×	
33	↗	↘	
34	↗	↘	
35	▲		
36	↗	↘	
37	↗		
38	↗	↘	
39	↗	↘	
40	↗	↘	
41	↗		
42	▲		
43	↗	×	
44	↗	↘	
45	↗	↘	
46	○		
47	↗	↘	
48	↗	×	
49	▲		
50	↗	↘	
51	▲		
52	↗		┌
53	↗	↘	
54	▩		└
55	▲		