

# Clark Community Park

Old Saybrook, CT, USA  
 scale 1:7500  
 contours 5 meters

- paved road, dirt road
- dirt parking area
- large path, small path
- faint path
- stone wall
- ruined wall
- uncrossable fence
- crossable fence
- buildings, ruin
- contours (5 meter)
- form line
- knolls
- depression, pit
- cliffs
- boulders, cluster
- disc golf hole
- private property
- open land
- rough open land
- semi-open land
- vegetation, slow
- vegetation, fight
- lake
- swamp
- crossable marsh

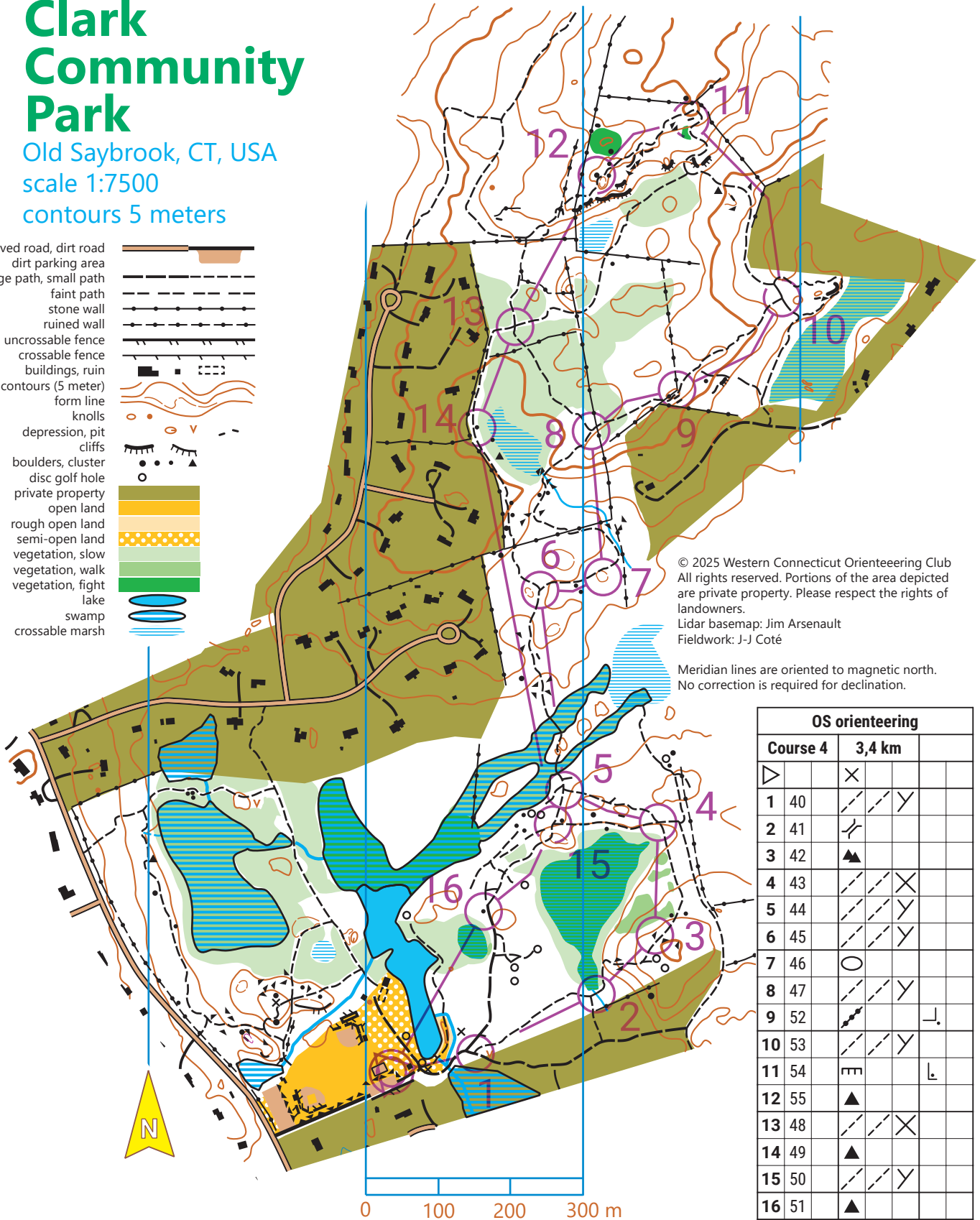

© 2025 Western Connecticut Orienteering Club  
 All rights reserved. Portions of the area depicted are private property. Please respect the rights of landowners.  
 Lidar basemap: Jim Arsenault  
 Fieldwork: J-J Côté

Meridian lines are oriented to magnetic north.  
 No correction is required for declination.

OS orienteering			
Course 4	3,4 km		
▷	×		
1 40	↗	↘	
2 41	↖		
3 42	▲		
4 43	↗	×	
5 44	↗	↘	
6 45	↗	↘	
7 46	○		
8 47	↗	↘	
9 52	↗		└
10 53	↗	↘	
11 54	▬		└
12 55	▲		
13 48	↗	×	
14 49	▲		
15 50	↗	↘	
16 51	▲		
○	260 m		○